

# NEW MEXICO BASKETBALL

## FACILITIES

### IN THIS SECTION

History of The Pit .....	74
Women's Basketball Locker Room .....	75
Practice Facility .....	76
The L.F. "Tow" Diehm Facility .....	77
Statistics at The Pit.....	78-83
Training Room/Weight Room .....	84





University Arena (otherwise known as "The Pit") has been home to Lobo women's basketball since the 1970s. In the early days, the 18,000-seat arena was simply a place for UNM to play its games; however, in the last 10 years, The Pit has taken on a special significance and become one of the best home-court advantages in women's college basketball. The Lobos have established a terrific winning tradition at home, compiling an impressive 143-30 (.827) mark in the last 10 seasons. Included in that record is a school-best 24-game home winning streak from 1998-99, which at the time was the second-longest in the country.

Perhaps the most astounding aspect of The Pit is the people who fill it... the fans. The Lobo women's program sold a total of nine season tickets in 1994-95 and averaged an attendance of just under 400. In 1995-96, Don Flanagan's first season, UNM sold 1,467 season tickets and averaged 3,501 fans per game, the 21st-best figure in the nation. Support has increased exponentially since, and in 2000-01 the Lobos drew a school-record 182,961 fans in 21 home games, which was the third-highest total in the nation. In 2002-03 UNM averaged a school-record 11,896 fans per game, good for fourth nationally, which is the highest the Lobos have ever ranked in NCAA stats for per game averages. Last season New Mexico was ranked fourth nationally for the third consecutive season with an average of 10,684 including eight crowds of over 10,000 during the year, including 16,084 on Senior Day for the Lobos game



The original gym was constructed in 1895 for the amazing cost of \$690. It measured 30'x50'. It was torn down in 1934.



New Mexico's home floor was opened December 1, 1966. Since that date over 10 million people have witnessed basketball games at University Arena.

against UNLV. The Pit also hosted the 2004 NCAA Tournament with an average attendance of 15,787. In 2003 The Pit led the NCAA Tournament in average attendance with 16,185 a game during four rounds of action. In 2001 UNM established a record crowd of 18,018 in the WNIT Championship game against Ohio State, the third capacity crowd in school history. UNM has been ranked in the top-15 for attendance in each of Flanagan's 10 years and has led the conference in fan support each time.



For Lobo men's games, the crowd noise has been estimated at 125 decibels (the pain threshold is 130), and the women's games have begun to attract similar fanaticism. As a result, The Pit, which ironically sits at 5,200 feet elevation, but is located 37 feet underground, has earned the reputation as being "A Mile High and Louder Than..."



Fan support for the women's basketball team has continued to grow year after year.



Women's basketball fans are a special breed and the Lobos are grateful for their support.



Like the Lobos themselves, the women's basketball locker room is bright, vibrant and works for the team. It's not an ornate or elaborate space, it's a practical layout. It's not overly done, just clean, modern and functional. The idea for the design was singular: the coach and players needed a space which supported team activity, not only room for lockers and changing, but also for training, coaching and supporting cohesiveness.

With an aggregate of 800 square feet, the old locker room had a mere 300 square feet of space in which the team could gather together. The renovation, which began August of 2002, netted them 40 percent more area and provided them with more than 850 square feet of group areas.

The aim for this project was to take the available space and make it work more efficiently. With the exception of two plumbing fixtures, the old locker room and neighboring press room were gutted from floor to ceiling.

A semi-circle of 15 new tall and slim wood paneled player's lockers radiate around a Lobo logo inset in the

cherry red carpet. Separated by custom-made brushed steel and frosted glass doors, the new team work room is loaded with audio-video equipment, maker boards, trophy cases, storage and seating. The ceramic tile pattern in the expanded shower/dressing room hints of a southwestern motif, while remaining true to the Lobos' colors. Special lighting highlights the custom floor and wall Lobo heads, emphasizing that this is clearly a locker room for Lobos.



**Special Thanks To:**

- |                              |                         |
|------------------------------|-------------------------|
| Molzen-Corbin & Associates   | Carpets by Sonia        |
| Amestoy Dri-Wall             | Grant Mechanical        |
| Century Drywall              | Utility Block           |
| Baillio's                    | Business Environments   |
| Harrison Contracting         | Darant Distributing     |
| Yearout Mechanical           | Star Sales Distributing |
| Mosher Enterprises           | Assoc. Concrete Cutting |
| Raylee Homes                 | Surfaces                |
| Ray's Flooring & Specialties | Kohler Sterling         |
| Paxton                       | Duke Insulation         |
| Kaufman Fire Protection      | Albuquerque Partitions  |
| OG Bradbury                  | Pace Iron Works         |
| Dwight's Glass & Mirror      | Ferfuson Enterprises    |
| Raysteel                     | Massey Johnson          |





The University of New Mexico will open a brand new basketball complex in November of 2005, that features a practice facility and new offices for the Lobo men's and women's basketball coaches and staff. The \$4.2 million project was funded by New Mexico Governor Bill Richardson and members of the state legislature during the 2004 and 2005 legislative sessions.

The facility will provide more than 26,000 square feet of space. In addition to the practice court and offices, the complex will have coaches' locker rooms, a video room, computer lab, hospitality area with a caterer's kitchen, media workroom and a stylish lobby entrance that will showcase the rich history and strong tradition of the men's and women's basketball programs.

The new facility was designed by the Albuquerque architectural firm of Molzen-Corbin & Associates. The general contractor is The Jaynes Corporation of Albuquerque.

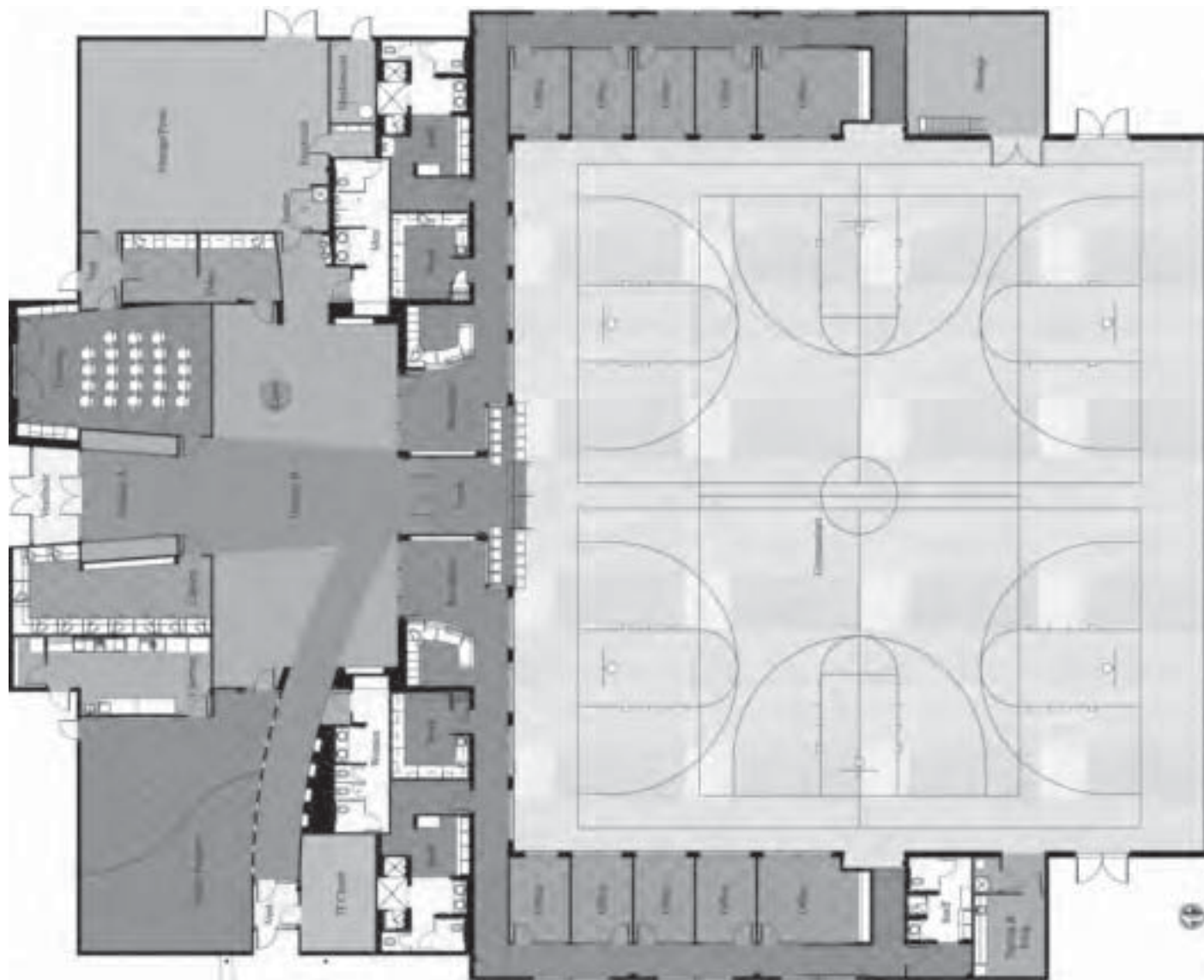



Facilities that benefit all student-athletes at The University of New Mexico continue to improve. The L.F. "Tow" Diehm Facility, named after the Lobos' long-time athletics trainer, is in the south end zone of University Stadium.

The first of three floors was completed prior to the start of the 1993 football season and encompasses the 10,000-square-foot All Sport Weight Room and a state-of-the-art sports medicine facility that is utilized by all of the school's student-athletes. A football locker room and equipment room that quadrupled the size of the old facility is also on the ground floor.

The second floor houses Lobo football coaches offices and meeting rooms. The third floor is a multi-purpose area that is used for academic services, plus meetings and functions throughout the year. Outdoor pavilions are also adjacent to the third floor.

Construction to the north end of the stadium was completed prior to the 2001 season. That addition added more than 5,700 seats, increasing capacity to more than 37,370. The south end will eventually be enclosed as well to allow more than 42,000 fans to watch Lobo football.

The Diehm Facility is just one part of an impressive array of facilities that covers nearly 200 acres. Across the street from University Stadium is The Pit, the 18,018-seat home to New Mexico basketball, long recognized as one of the loudest arenas in all of college basketball. More than eight million fans have flocked into this sunken edifice to watch their beloved Lobos. The facility was the site of the 1983 Final Four and has hosted numerous NCAA and Western Athletic Conference championships, including the 1992 NCAA Women's Volleyball Championship and the 1993 NCAA Men's Gymnastics Championships. UNM also hosted the 1996 WAC Basketball Tournament for both men and women, the 1996, 2000 & 2002 NCAA West Regional First and Second Round in men's basketball, 2005 NCAA Albuquerque Regional Semifinals and Finals and the 2003 and 2004 First and Second Round and 2003 Regionals for women's basketball. This year The Pit will again be the site for the NCAA Women's Basketball Albuquerque Regional semifinals and finals.

Excellent facilities do not stop with just football and basketball. The Lobo Tennis Club features 13 courts, with six lighted outdoor courts, the Randy Briggs Indoor Tennis Dome and the First State Bank Bubble, provides six courts for indoor play. The UNM Track Stadium/Soccer Complex is a 5,000-seat facility with an all-weather Versaturf surface for track and a natural grass surface for soccer.

The Championship Golf Course has been ranked among the nation's Top 25 public courses by Golf Digest magazine and has been host to several collegiate championships, including the 1987 NCAA Women's Championships and the 1976, 1992 & 1998 NCAA Men's Championships. Additionally, Isotopes Park for baseball and softball complete the impressive array of athletics facilities at UNM.

On the main campus of the university is Johnson Arena, home of Lobo volleyball, and Johnson Pool, site of UNM's home swim meets.



**The L.F. "Tow" Diehm Athletics Facility is a 60,000-square-foot facility utilized by all of New Mexico's student-athletes. The weight room (above) is state-of-the-art and is considered one of the top training facilities in the country.**

## Quick Facts about... THE L.F. "TOW" DIEHM FACILITY

- Total Square Feet: 60,000
- STRENGTH AND CONDITIONING: 10,000-square-feet capable of accomodating 100 people at a time...10,000 pounds of free weights and more than \$70,000 worth of exercise machines
- SPORTS MEDICINE AND REHABILITATION: Utilized by all UNM student-athletes...An expansive 8,500-square-foot area...X-ray machine on site...Individual examination rooms for physicians
- PRESIDENT'S PAVILION (3rd Floor): Glassed-in area used throughout the year for football games and special events...Outside pavilions on each side available for rent during the football season.



# UNIVERSITY AR



## SPORTS ILLUSTRATED'S TOP-20 VENUES OF THE CENTURY

In June, 1999, Sports Illustrated listed its top-20 sporting venues of the century and The Pit checked in at No. 13. The list:

1. Yankee Stadium, Bronx, N.Y.
2. Augusta National Golf Course, Augusta, Ga.
3. Michie Stadium (Army football), West Point, N.Y.
4. Cameron Indoor Stadium (Duke basketball), Durham, N.C.
5. Bislett Stadium (track and field), Oslo, Norway
6. Wrigley Field, Chicago, Ill.
7. Roland Garros, Paris, France
8. Lambeau Field, Green Bay, Wis.
9. Fenway Park, Boston, Mass.
10. Saratoga Race Track, Saratoga, N.Y.
11. Pebble Beach Golf Course, Monterey, Calif.
12. Wembley Stadium (soccer), London, England
13. **THE PIT, ALBUQUERQUE, N.M.**
14. Boston Marathon Course, Boston, Mass.
15. Camden Yards, Baltimore, Md.
16. Lamade Stadium (Little League World Series), Williamsport, Pa.
17. Daytona International Speedway, Daytona, Fla.
18. Notre Dame Stadium, South Bend, Ind.
19. St. Andrews Golf Course, Scotland
20. Rose Bowl, Pasadena, Calif.



## A Mile H



# ARENA "THE PIT"



## 2002-2003 NCAA TOURNAMENT ATTENDANCE

### First and Second Round

Rank	Attendance	Average	Location
1.	32,365	16,185	Albuquerque, N.M.
2.	22,266	11,133	Manhattan, Kan.
3.	22,039	11,020	Lubbock, Texas
4.	17,818	8,909	Storrs, Conn.
5.	15,456	7,728	University Park, Pa.
6.	13,787	6,894	Knoxville, Tenn.
7.	10,240	5,120	Raleigh, N.C.
8.	10,091	5,046	West Lafayette, Ind.
9.	9,090	4,545	Norfolk, Va.
10.	9,033	4,517	Boulder, Colo.
11.	8,631	4,316	Ruston, La.
12.	7,594	3,797	Norman, Okla.
13.	7,510	3,755	Cincinnati, Ohio
14.	6,468	3,234	Athens, Ga.
15.	6,146	3,073	Stanford, Calif.
16.	5,569	2,785	Eugene, Ore.

### Regionals

Rank	Attendance	Average	Location
1.	28,595	14,298	Albuquerque, N.M.
2.	20,714	10,357	Knoxville, Tenn.
3.	18,055	9,028	Dayton, Ohio
4.	6,580	3,290	Stanford, Calif.



# High And Louder Than...



# Lobos In

## LONGEST HOME WINNING STREAKS IN SCHOOL HISTORY

<u>Rank</u>	<u>Length</u>	<u>Began</u>	<u>Ended</u>
1.	24	Jan. 11, 1998 – UNM 72, Wyoming 45	March 17, 1999 – Drake 73, UNM 60
2.	14	Dec. 10, 2004 – UNM 73, Bowling Green 43	Current
3.	10	Jan. 11, 2003 – UNM 70, Weber State 57	March 29, 2003 – Texas Tech 71, UNM 48
4.	9	Jan. 21, 1984 – UNM 80, N. Arizona 74	Jan. 2, 1985 – Oregon 79, UNM 49
	9	Jan. 6, 1977 – UNM 63, N.M. State 54	March 10, 1978 – Utah 70, UNM 64

## 2004-05 NCAA SINGLE-GAME ATTENDANCE HIGHS (Regular Season)

UNM holds the 15th and 20th single-game attendance marks for the 2004-05 NCAA women's basketball regular season. The top three attendances are held by the University of Tennessee, which plays its home games in the 25,000-seat Thompson-Boling Arena. Also in the top-15 is the University of Connecticut, at the 16,294-seat Hartford Civic Center, Ohio State at the 19,200-seat Value City Arena and Maryland at the 17,950-seat Comcast Center.

<u>Rank</u>	<u>Attendance</u>	<u>Date</u>	<u>Location</u>	<u>Result</u>
1.	22,515	2-5-04	Knoxville, Tenn.	UConn 81, Tennessee 67
1	18,643	2-13-05	Knoxville, Tenn.	Tennessee 72, Vanderbilt 63
2	18,633	1-13-05	Knoxville, Tenn.	Tennessee 72, Arkansas 54
3	17,525	2-27-05	Columbus, Ohio	Penn St. 69, Ohio St. 62
4	17,243	2-13-05	College Park, Md.	Duke 60, Maryland 49
5	16,471	1-23-05	Knoxville, Tenn.	Tennessee 67, Kentucky 49
6	16,294	12-5-04	Hartford, Conn.	UConn 75, Holy Cross 36
7	16,294	12-7-04	Hartford, Conn.	UConn 55, Hartford 32
8	16,294	12-27-04	Hartford, Conn.	UConn 75, George Mason 44
9	16,294	12-29-04	Hartford, Conn.	Michigan St. 67, UConn 51
10	16,294	1-8-05	Hartford, Conn.	Tennessee 68, UConn 67
11	16,294	1-17-05	Hartford, Conn.	UConn 73, Texas 57
12	16,294	1-22-05	Hartford, Conn.	UConn 64, Seton Hall 47
13	16,294	2-3-05	Hartford, Conn.	UConn 57, Rutgers 44
14	16,294	2-19-05	Hartford, Conn.	UConn 85, Syracuse 49
15	16,084	2-26-05	Albuquerque, N.M.	New Mexico 68, UNLV 65



# The Pit...



## UNM IN TOP TEN NCAA ATTENDANCE

1998-99		
1.	Tennessee	16,565
2.	Connecticut	10,867
3.	Purdue	9,681
4.	Texas Tech	8,051
5.	SW Missouri State	7,613
6.	Ohio State	7,588
7.	Wisconsin	7,566
<b>8.</b>	<b><i>New Mexico</i></b>	<b>7,470</b>

1999-00		
1.	Tennessee	15,341
2.	Texas Tech	12,741
3.	Connecticut	11,632
4.	Iowa State	11,814
5.	Purdue	9,280
<b>6.</b>	<b><i>New Mexico</i></b>	<b>8,918</b>

2000-01		
1.	Tennessee	15,510
2.	Texas Tech	12,660
3.	Connecticut	12,265
4.	Iowa State	11,370
<b>5.</b>	<b><i>New Mexico</i></b>	<b>8,872</b>

2001-02		
1.	Tennessee	14,295
2.	Texas Tech	12,545
3.	Connecticut	11,907
4.	Iowa State	10,296
<b>5.</b>	<b><i>New Mexico</i></b>	<b>9,229</b>

2002-03		
1.	Tennessee	12,902
2.	Connecticut	12,802
3.	Texas Tech	12,204
<b>4.</b>	<b><i>New Mexico</i></b>	<b>11,896</b>

2003-04		
1.	Tennessee	14,403
2.	Connecticut	13,435
3.	Texas Tech	12,577
<b>4.</b>	<b><i>New Mexico</i></b>	<b>11,865</b>

2004-05		
1.	Connecticut	13,613
2.	Tennessee	13,449
3.	Texas Tech	12,601
<b>4.</b>	<b><i>New Mexico</i></b>	<b>10,674</b>

## UNM ATTENDANCE FIGURES (1995-2005)

<u>Year</u>	<u>Total</u>	<u>Games</u>	<u>Avg.</u>	<u>National Rank</u>
95-96	56,018	16	3,501	21st
96-97	63,222	13	4,863	11th
97-98	85,172	17	5,010	13th
98-99	134,452	18	7,470	8th
99-00	151,613	17	8,918	6th
00-01	218,943	25	8,872	5th
01-02	156,895	17	9,229	5th
02-03	226,024	19	11,896	4th
03-04	213,575	18	11,865	4th
04-05	181,465	17	10,674	4th



# Lobos In

## UNM'S TOP CROWDS

Rank	Att.	Date	Opponent	UNM Result
1.	18,018	2-23-99	UTEP	W, 64-61
	18,018	2-5-00	BYU	W, 65-59
	18,018	3-28-01	Ohio State	L, 64-61
	18,018	2-1-03	UNLV	W, 65-60
	18,018	1-31-04	UNLV	W, 70-66
6.	17,578	3-8-03	BYU	W, 63-44
7.	17,472	3-6-04	Colorado State	W, 59-52
8.	17,215	1-6-02	UNLV	L, 62-53
9.	17,213	2-4-97	Utah	L, 53-49 (OT)
10.	17,166	2-26-00	Colorado State	W, 67-59
11.	16,845	1-7-01	Utah	L, 76-73
12.	16,214	2-24-03	Mississippi State	W, 73-61
13.	16,182	3-29-03	Texas Tech	L, 71-48
14.	16,151	3-23-03	Miami	W, 91-85 OT
15.	16,087	2-27-99	Utah	W, 52-45
<b>16.</b>	<b>16,084</b>	<b>2-26-05</b>	<b>UNLV</b>	<b>W, 68-65</b>
17.	16,029	3-20-04	Florida	L, 68-56
<b>18.</b>	<b>14,890</b>	<b>1-22-05</b>	<b>Utah</b>	<b>W, 61-55</b>
19.	14,561	2-22-03	Colorado State	W, 74-54
20.	14,348	2-21-04	BYU	W, 60-59
21.	13,350	1-18-03	Air Force	W, 93-57
22.	13,147	2-21-98	TCU	W, 74-55
23.	13,109	2-10-01	Air Force	W, 65-52
24.	12,868	2-23-02	San Diego State	W, 63-53
25.	12,333	3-6-03	Utah	W, 51-48
26.	11,986	12-20-03	Arizona	L, 50-49
27.	11,872	1-19-02	Utah	W, 66-55
28.	11,827	12-14-03	New Mexico State	W, 62-39
29.	11,816	11-21-03	USC	W, 77-75
30.	11,692	2-19-04	Utah	W, 49-46
31.	11,684	2-14-04	Air Force	W, 65-43
32.	11,677	2-7-99	Hawaii	W, 69-55
<b>33.</b>	<b>11,551</b>	<b>2-5-05</b>	<b>Colorado State</b>	<b>W, 75-49</b>
34.	11,484	12-7-02	Texas	W, 77-70
<b>35.</b>	<b>11,229</b>	<b>12-18-04</b>	<b>Arizona State</b>	<b>W, 61-45</b>

Bold indicates it was set last season

## THE 24-GAME WIN STREAK

A list of UNM's victims from a school-record 24-game home win streak between 1998-99:

Date	Opponent	Score
1-11-98	Wyoming	W, 72-45
1-24-98	Texas-El Paso	W, 61-56 (OT)
1-29-98	#9 Utah	W, 76-59
1-31-98	Brigham Young	W, 75-63
2-12-98	Air Force	W, 91-45
2-15-98	UNLV	W, 89-69
2-21-98	TCU	W, 74-55
11-14-98	Northern Arizona	W, 67-49
11-15-98	Northwestern	W, 73-68
11-19-98	Montana State	W, 56-39
11-21-98	Wichita State	W, 71-57
12-4-98	North Texas	W, 66-53
12-5-98	Northeast Louisiana	W, 64-50
12-12-98	New Mexico State	W, 57-43
12-19-98	Houston	W, 77-61
1-14-99	Fresno State	W, 71-62
1-16-99	San Jose State	W, 66-43
1-23-99	Texas-El Paso	W, 64-61
2-4-99	San Diego State	W, 75-51
2-7-99	Hawai'i	W, 69-55
2-25-99	Brigham Young	W, 68-60
2-27-99	Utah	W, 52-45
3-12-99	Pepperdine	W, 81-69
3-14-99	Washington	W, 68-63

## Won-Loss Record with crowds over 10,000

W	L	Pct.
40	15	.727



# The Pit...

"All fans, whether they've watched the game live for 10 years or just been to their first game this season, are winners in our book. Picking one group is tough, especially since so many teams drew record crowds this season. And while some say there are no better fans than those found in Knoxville or Storrs, we're leaning toward those loco Lobos fans. New Mexico ranked fifth in attendance last season, averaging just less than 10,000 fans. The Jan. 6, 2002, game against UNLV ranked as the fifth-best attended game (17,215 fans) last season. But it's the top drawing game that didn't feature either Tennessee or UConn. Even a blizzard didn't stop them from packing the house."

— *Melanie Jackson*  
ESPN.com

## UNM RECORD IN THE PIT

(SINCE 1991-92, THE REINSTATEMENT OF THE BASKETBALL PROGRAM)

Year	Overall				Conference		
	Games	W	L	Pct.	W	L	Pct.
1991-92	13	2	11	.154	0	7	.000
1992-93	13	5	8	.385	3	4	.428
1993-94	12	2	10	.167	1	6	.143
1994-95	14	5	9	.357	2	5	.286
1995-96	16	11	5	.688	5	2	.714
1996-97	13	11	2	.846	6	2	.750
1997-98	17	14	3	.824	6	1	.857
1998-99	18	17	1	.944	7	0	1.000
1999-00	17	13	4	.765	6	1	.857
2000-01	21	16	5	.761	5	2	.714
2001-02	17	14	3	.823	7	1	.875
2002-03	19	17	2	.895	7	0	1.000
2003-04	18	14	4	.777	7	0	1.000
2004-05	17	16	1	.941	7	0	1.000
Totals	225	157	68	.697	69	31	.690
Totals 95-05	173	143	30	.827	63	9	.875

