

LONG BEACH STATE ATHLETICS FACILITIES

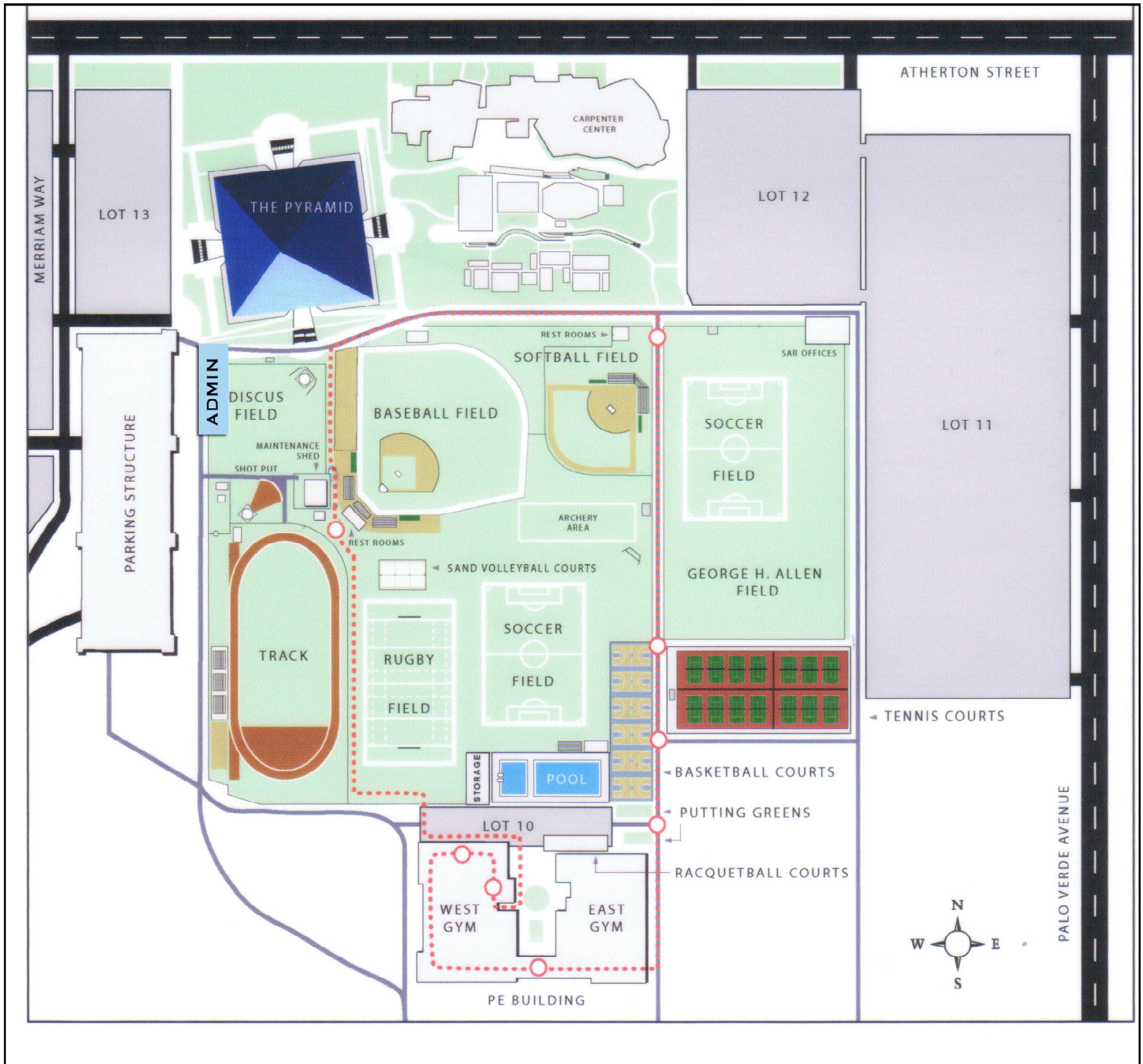

The Walter Pyramid / Administration

Atherton and Meridian, between Bellflower and Palo Verde on the Long Beach State Campus

- Take the San Diego (405) Freeway to the Palo Verde Avenue off-ramp.
- Go South at light (left from northbound 405/right from southbound 405) onto Palo Verde. Stay on Palo Verde for approximately 1/2 mile, until Atherton Street, and turn right.
- Turn left at first light, which is Merriam Way. (If you cannot find The Walter Pyramid at this point, you're in big trouble! It's the 18-story blue building shaped like a pyramid on your left.)
- The 49er Athletic Offices are adjacent to The Walter Pyramid next to the parking structure.

Blair Field; Off Campus Home of "Dirtbag" Baseball
4700 Deukmejian Drive, Long Beach, CA

From the 405 Freeway:

Take Bellflower South, passing the campus on your left until seventh street. Make a right on seventh street and go past the golf courses on either side (about 3-4 blocks) and make a right on Park Ave. If you hit Ximeno (or pass Wilson High you've gone too far!)

Softball, Soccer, Tennis, Pool, Training Room

Once on Bellflower... (to softball and soccer fields/tennis) turn left on Atherton, pass The Walter Pyramid and turn right just past Carpenter Center (before light). At end of parking lot, soccer field is straight ahead, softball field is to the right. Tennis courts are behind soccer fields.

(to pool/West Gym/Training Room) turn left on Atherton and proceed pass The Walter Pyramid to Palo Verde. Turn Right. Proceed to end of the block at the "T" and turn right. Go about a half block down and turn right at Deukmejian Way. Follow road around and turn left at basketball courts/tennis courts and than right into parking lot. Pool is on the right and the West Gym, and training room are to the left. The training room is located in the main hallway (next to the weight room and open aired quad on the right side if you have your back to the pool)