

Kinney Natatorium



VISITOR'S GUIDE

TABLE OF CONTENTS

KINNEY NATATORIUM INFORMATION	1
TICKET OFFICE	2
GUEST WITH DISABILITIES	2
RULES AND REGULATIONS	2
POOL LAYOUT	3
DIRECTIONS TO ATHLETIC FACILITIES	4
MAP OF CAMPUS	5
HOTEL AND TRAVEL INFORMATION	6
RESTAURANTS	7
SHOPPING & ENTERTAINMENT	8
HOSPITALS	8

Arthur D. Kinney Jr. Natatorium

Bucknell University

Lewisburg, PA 17837

PROUD HOST OF THESE MAJOR EVENTS:

2005 & 2006 PIAA Swimming & Diving Championships

2005 NCAA Division I Men's Water Polo National Championships

2004 CWPA Men's & Women's Eastern Water Polo Championships

2004 Eastfield Regional Swimming Championships

2003 Middle Atlantic Senior Long Course Championships

2003 CWPA Men's & Women's Southern Division Water Polo Championships

2003 Patriot League Swimming & Diving Championships

The Kinney Natatorium which opened October 2002, features a 50 meter by 25 yard pool which accommodates four varsity programs- men's and women's swimming & diving and men's and women's water polo. The pool features two moveable bulkheads, allowing for multiple team practices and recreational swimming to occur simultaneously. Natatorium amenities include permanent seating for 500 spectators, restrooms, varsity and recreational locker rooms, a poolside classroom, sauna, steam room and concession stands.

Logistical Information

Pool Size

- 25 Yards x 50 meters
- 2 movable bulkheads
- 22 lanes x 25 yards (width-wise)
- 8 Lanes x 25 yards, 25 meters, or 50 meters (length-wise)
- Pool can also be set up for water polo with 25 meters for women, or 30 meters for men.
- All deck markings, lane lines, and goals are provided.

Ticket Office Information

- The Campus Box Office is located at the Weis Center for Performing Arts on the Bucknell University campus near the Christy-Mathewson Stadium.
- The Natatorium event day ticket office is located at the main entrance of Sojka Pavilion for ticket sales, and will call.
- Ticket windows will open approximately 1 hour prior to the beginning of athletic contests.
- For additional information, contact the Ticket Office at (570)577-1000.
- Will call services require proper picture identification before receiving tickets
- ***Children under the age of 2 years old will be permitted into the natatorium at no charge, but are required to share seating with guardian***

Guests with Disabilities

- Seating is available on the concourse level in the spectator seating area of Kinney Natatorium. An elevator is located at the main entrance of the building to provide access to the concourse level.
- Listening devices can be obtained for guests with hearing impairments prior to the scheduled events at the Natatorium.

Rules and Regulations

Alcohol Consumption

- No alcoholic beverages may be purchased or brought into the Pavilion or Natatorium during scheduled events

Conduct of guests in attendance

- Bucknell University promotes the highest standards of sporting behavior from their student-athletes, coaches and spectators. We encourage all fans to enthusiastically support all the participants and ask that your enthusiasm be expressed in a sporting-like manner. Disrespectful behavior or comments directed at officials, student-athletes, coaches, team representatives or fellow fans are inappropriate and are grounds for removal from the premises.

Banners

- Banners are not permitted without the direct consent of the Aquatics Director. Contact Pam Arnold for further information. (pamold@bucknell.edu or 570-577-3594)

Smoking

- Smoking will not be permitted inside the facility or any other campus building.

Items not permitted during athletic/external events

- Animals (except service animals)
- Glass containers
- Skateboards/Rollerblades
- Artificial noise makers
- Weapons or Dangerous materials

Bucknell University

Recreation & Athletics Center -- Ground Floor
Kinney Natatorium

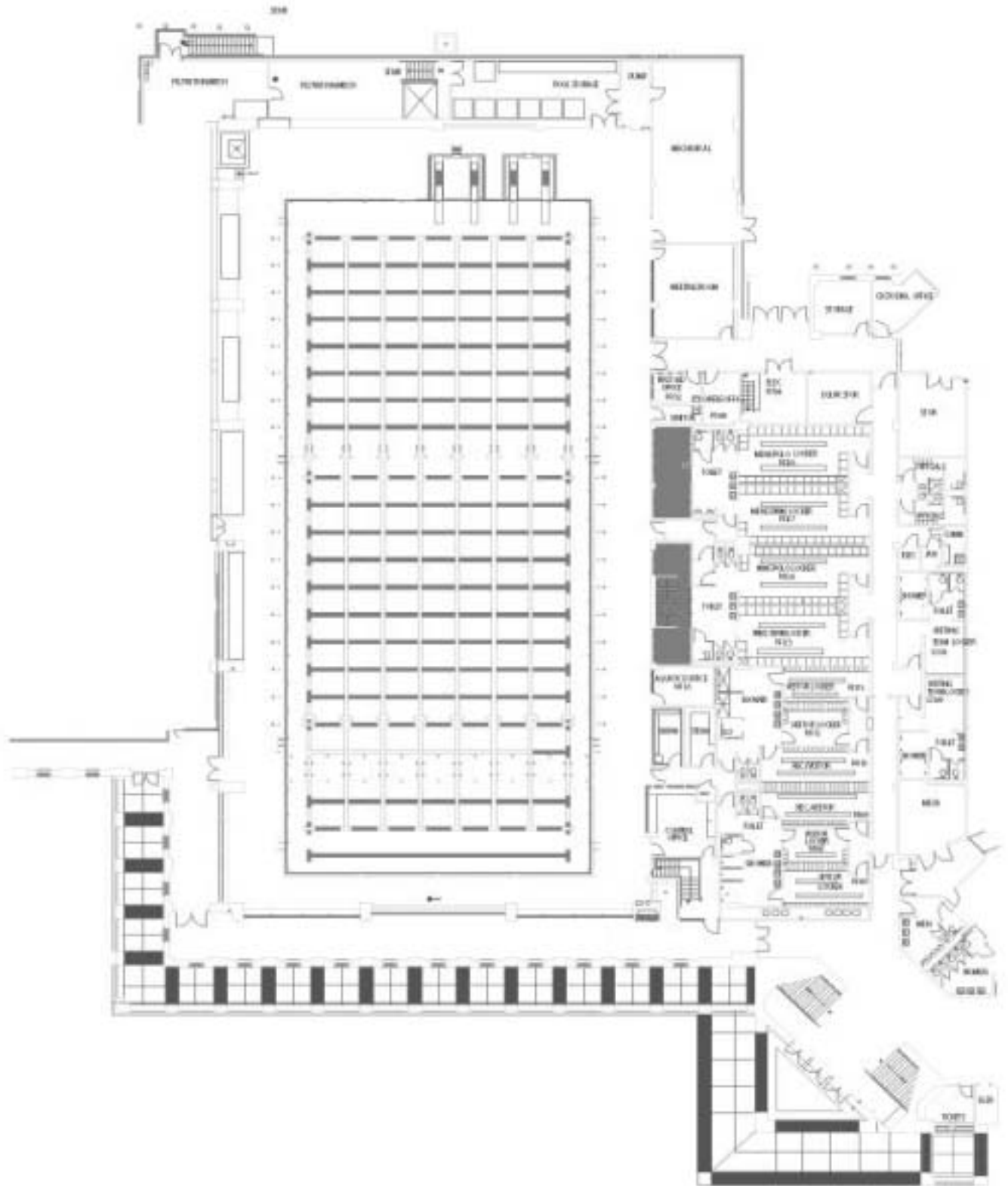

DIRECTIONS TO THE BUCKNELL CAMPUS

Kenneth Langone Athletics & Recreation Center (KLARC)

-Turn directly off Route 15 onto Moore Avenue to enter the Bucknell campus. The **Kenneth Langone Athletics and Recreation Center**, which houses Sojka Pavilion, and Kinney Natatorium will appear on your left.

-Various parking lots are located at the south entrance to the Kenneth Langone Athletics and Recreation Center. Handicapped parking spaces can also be found at the main entrance to the Recreation and Athletic Center. Team buses are required to park at Christy Mathewson Memorial Stadium upper lot or Faculty Court lot located off Moore Avenue near Route 15.

From additional locations:

From Philadelphia - Take the Northeast Extension of the Pennsylvania Turnpike north to Interstate 80 East. Take I-80 to Route 15 South (Exit 210A). Follow Route 15 South. At the seventh traffic light make a left at Moore Avenue onto the Bucknell Campus.

From Baltimore - Take Interstate 83 North and pick up Route 15 North just south of Harrisburg. Follow Route 15 for approximately 60 miles. Approximately seven miles after passing through Selinsgrove you will crest a hill with a flashing traffic light warning signal. At the traffic light at the bottom of the hill turn right on Moore Avenue into campus.

From Pittsburgh - Take U.S. Route 22 East to 220 North (I-99). Continue until reaching Interstate 80 East. Take I-80 to Route 15 South (Exit 210A). At the seventh traffic light make a left at Moore Avenue into campus.

From Washington D.C. and south - Take 495 to I-270 North and pick up route 15 North near Frederick. Follow Route 15 for approximately 60 miles. Approximately seven miles after passing through Selinsgrove you will crest a hill with a flashing traffic light warning signal. At the traffic light at the bottom of the hill turn right on Moore Avenue into campus.

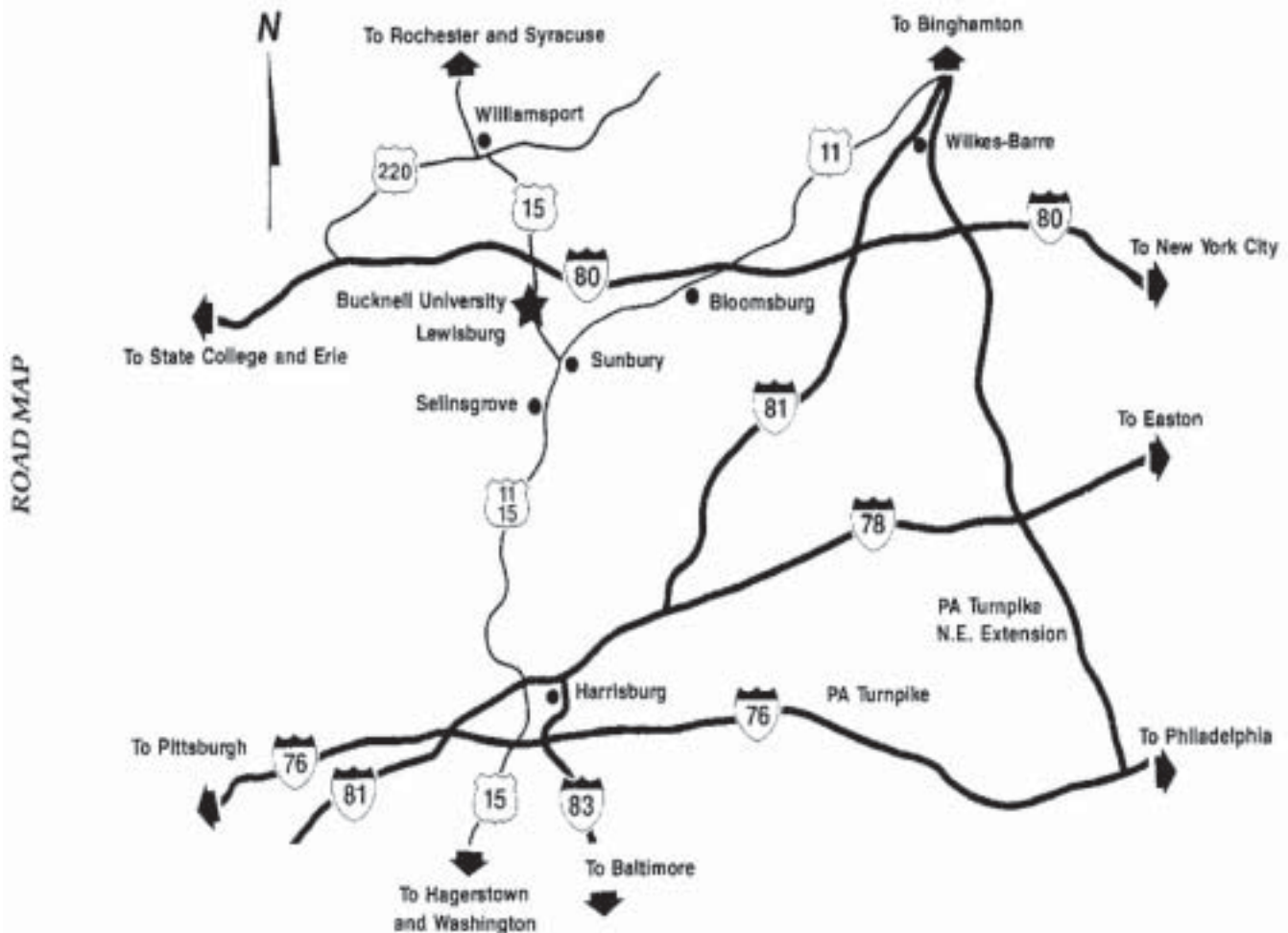

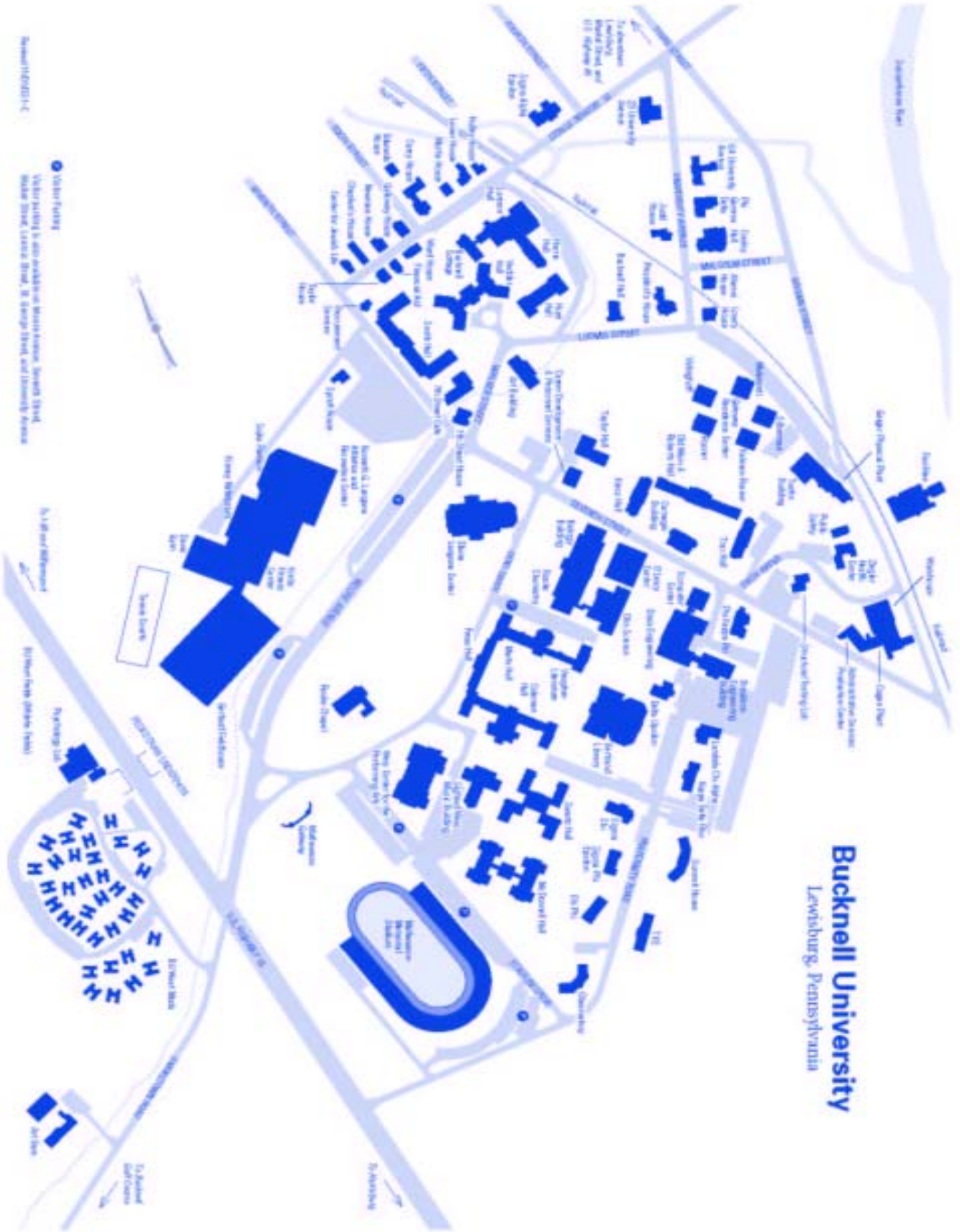

Number 110001-14

Visitor Parking

Visitor parking is also available in various locations. Bucknell Street, Main Street, Center Street, W. Campus Street and University Avenue.

N. W. 8th Street (off-campus)

Elk River (public transit)

Apprentice Inn

Elk River Plaza

10. Bucknell
Campus

Bucknell University
Lewisburg, Pennsylvania

HOTELS & LODGING

Country Cupboard Inn
Rt. 15 N.
Lewisburg, PA
570/524-5500

Days Inn Lewisburg
Rt. 15 N.
Lewisburg, PA
570/523-1171

The Lewisburg Hotel
136 Market Street
Lewisburg, PA
570/524-6200

Econo Lodge
Rt. 15 S.
Lewisburg, PA
570/523-1106

Pineapple Inn (B & B)
439 Market Street
Lewisburg, PA
570/524-6200

Valley Lodge
Rt. 11 & 15
Hummels Wharf Selinsgrove, PA
570/743-0801

Comfort Inn
710 S. US 11/15
Selinsgrove, PA
570/374-8880

TRANSPORTATION

BUSES- CHARTER & RENTAL

Suquehanna Trailways
Williamsport, PA
800/692-6314

TAXI SERVICE

Aurora Taxi Inc.
Lewisburg, PA
570/523-1400

AIRPORTS

Wilkes-Barre/ Scranton International
877/235-9287 (50 Miles)

Harrisburg International
888/442-5387 (64 Miles)

Williamsport Regional
570/368-2417 (25 Miles)

Quality Inn Suites
Rt. 11 & 15
Shamokin Dam, PA
570/743-1111

Hampton Inn
Rts. 11 & 15
Shamokin Dam, PA
570/743-2223

The Comfort Inn
I-80 & Rt. 15
New Columbia, PA
570/568-8000

Holiday Inn Express
I-80 & Rt. 15
New Columbia, PA
570/568-1100

Holiday Inn Express
80/15
Commerce Park New Columbia, PA
570/568-1100

Pau-Lyns Country Bed & Breakfast
1160 Broadway Road
Milton PA
570/742-4110

Shangri-La On the Creek
670 Hidden Paradise Road
Milton PA
570/524-4561

CAR/VAN RENTAL

Buck's Car Rental & Sales
Rt. 15
Lewisburg, PA
570/524-0000

Enterprise Rent-A-Car
Rt. 11 & 15
Lewisburg, PA
570/522-9669

U-Save Auto Rental
Rt. 15 & 7
Lewisburg, PA
570/524-0000

Xpress Rent-A-Car
Rt. 104 S.
Mifflinburg, PA
570/966-4550

RESTAURANTS

Pizza Hut
Rt. 15
Lewisburg, PA
570/523-1195

Country Cupboard, Inc.
Route 15 and Hafer Road
Lewisburg, PA
570/523-3211

Elizabeth's An American
Bistro
412 Market St.
Lewisburg, PA
570/523-8088

Bleu Plate Cafe &
Cookshop
406 Market Street
Lewisburg, PA
570/524-9828

Victorian Lady
2167 Old Turnpike Road
Lewisburg PA
570/523-8090

Bull Run Inn/Rusty's
Market Street
Lewisburg, PA
570/524-2572

Bechtel's
Rt. 15
Lewisburg, PA
570/524-2229

Temperence House
50 North 2nd Street
Lewisburg, PA
570/524-2558

La Primavera Italiano
Ristorante
2593 Old Turnpike Rd.
Lewisburg, PA
570/523-1515

Town Tavern
600 Market Street
Lewisburg, PA
570/524-0821

Perkins
Rt. 15
Lewisburg, PA
570/523-7733

Bucknell Dining Services
Contact: Tim Tennon
570/577-1240
Fax: 570/577-1577

Front Street Station
2 Front St.
Northumberland, PA
570/473-3626

Bonanza Family Restaurant
I-80 & Rt. 15
New Columbia, PA
570/568-1200

B. J's Steak & Rib House
17 N. Market Street
Selinsgrove, PA
570/374-9841

Tedd's Landing
PO Box 132
Shamokin Dam, PA
570/743-1591

FAST FOOD

KFC/Taco Bell
Rts. 11 & 15
Lewisburg, PA
570/524-2465

Burger King
Rt. 15
Lewisburg, PA
570/524-4838

Italian Terrace Express
Market Street
Lewisburg, PA

McDonalds
Rt.15
Lewisburg, PA
570/524-7022

Dunkin' Donuts
Rt. 15
Lewisburg, PA
570/524-7495

Vennari's Pizza
610 Market St.
Lewisburg, PA

Dor-Days Sub Shop
1226 W. Market St.
Lewisburg, PA
570/524-7481

Wendy's
Rt. 15
Lewisburg, PA
570/524-7040

Subway
Market St.
Lewisburg, PA
570/523-7827

SHOPPING & ENTERTAINMENT

MOVIE THEATERS

Campus Theatre
413 Market St.
Lewisburg, PA
570/524-9628

Cinema Center
Susquehanna Valley Mall
Rts. 11 & 15
Selinsgrove, PA
570/374-2049

Point Drive In Theatre
Rt. 11 & Northumberland -Danville Hwy
Danville, PA
570/275-9926

HOSPITALS

Evangeical Community Hospital
Lewisburg, PA
570/522-2000

Geisinger Medical Center
Danville, PA
800/275-6401

Sunbury Community Hospital
Sunbury, PA
570/286-3333

SHOPPING

Susquehanna Valley Mall
Rts. 11 & 15
Selinsgrove, PA
570/374-8222

Wal- Mart
Rts. 11&15
Lewisburg, PA
570/522-8200

SUPERMARKETS

Giant
Orchard Hills Shopping Center
Shamokin Dam
570/743-1266

Weis Markets
122 JPM Rd
Lewisburg, PA
570/524-2915